

# LES MUSES

Détail panneaux bas/haut // assemblage

23/40

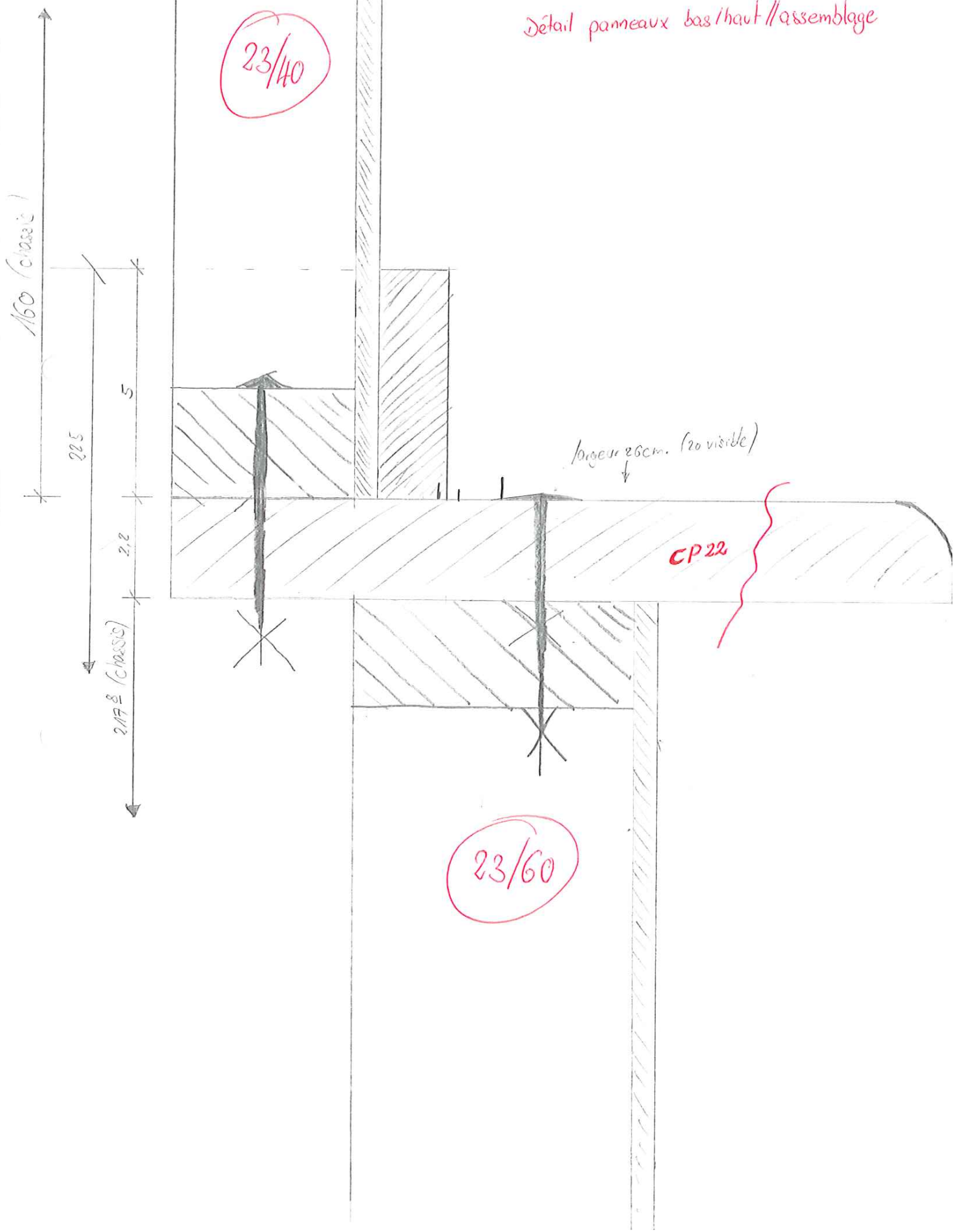

PLAN  
 2,5 m = 1 m  
 5 m = 2 m

1x pièce centrale pour dico sol

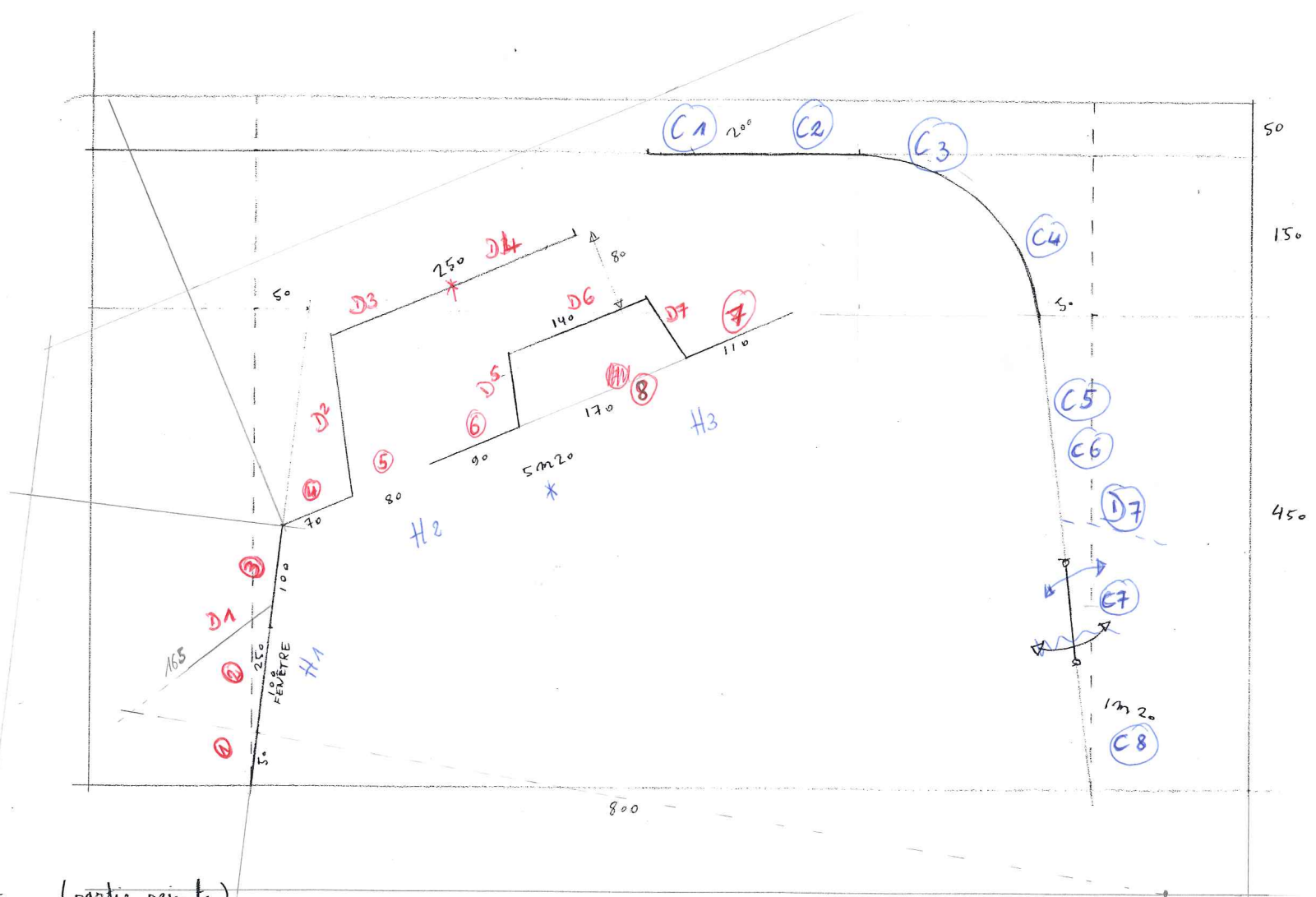

280

6,50

H = 2,25 m (partie peinte)  
 H = 2,00 m des portes  
 H = 3,80 (total)

- porte à rem joint dorsals

PLAN 2,5 cm = 1 m  
5 cm = 2 mm

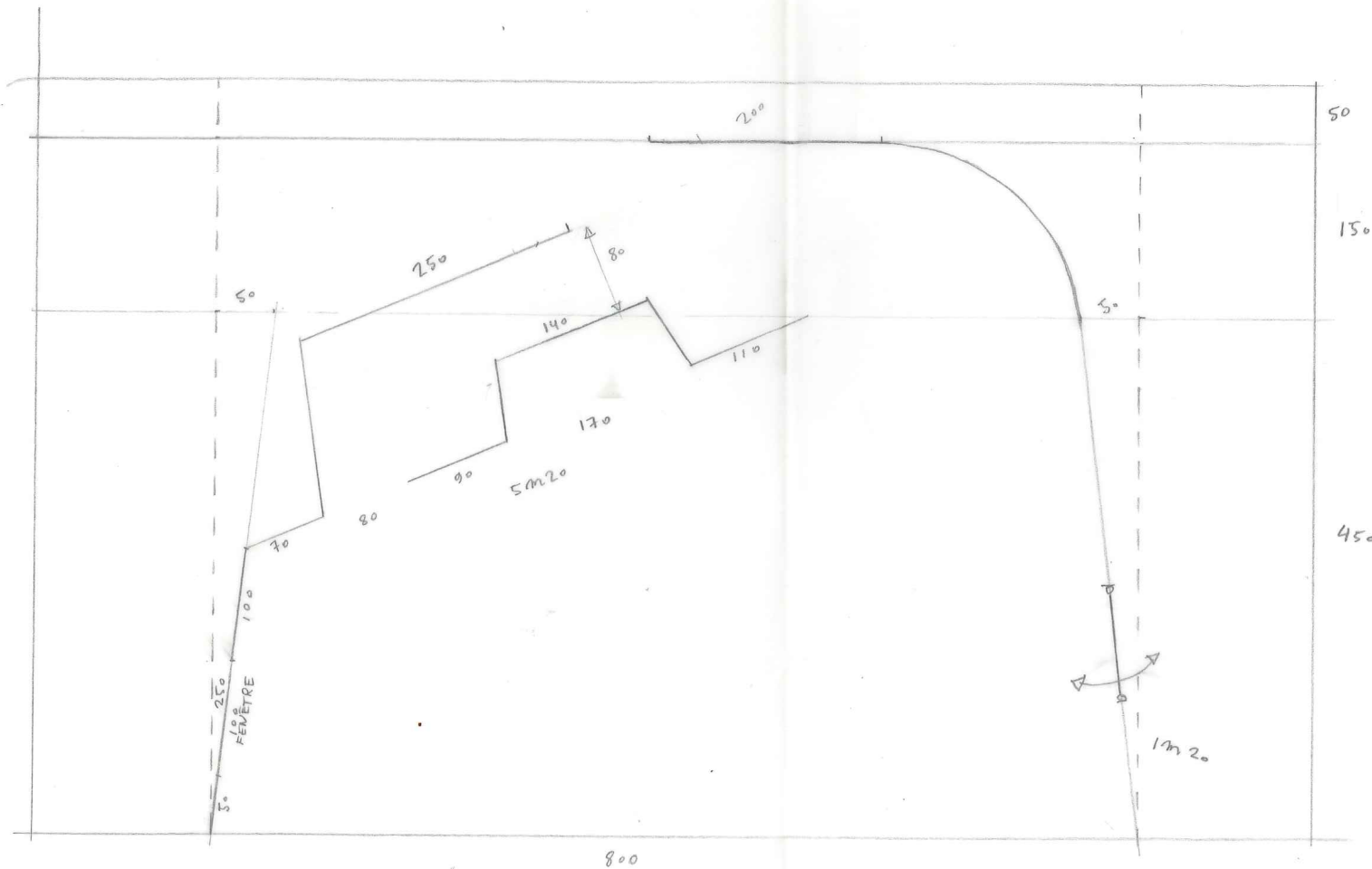

H = 2,25 m (partie peinte)  
H = 2,00 m des portes  
H = 3,80 (total)